



DVD58

COMPACT BRAZED HEAT EXCHANGER

High performance True Dual evaporator: the DV-type

The DV58 is a highly effective, versatile True Dual that is a natural choice for flexible chillers and climate control applications. Its advantage is its ability to offer full performance at both full and half load.

Easy to choose the right product solution

With SWEP's unique SSP CBE, the SWEP Software Package, you can do advanced heat transfer calculations yourself, and choose the product solution that suits your application best. It's also easy to choose connections and generate drawings of the complete product. If you would like advice, or you would like to discuss different product solutions, SWEP offers all the service and support your need.

THIRD-PARTY APPROVALS (selection)

Europe, Pressure Equipment Directive (PED 97/23/EC)

For additional information please contact your local SWEP representative. SWEP reserves the right to make changes without prior notice.

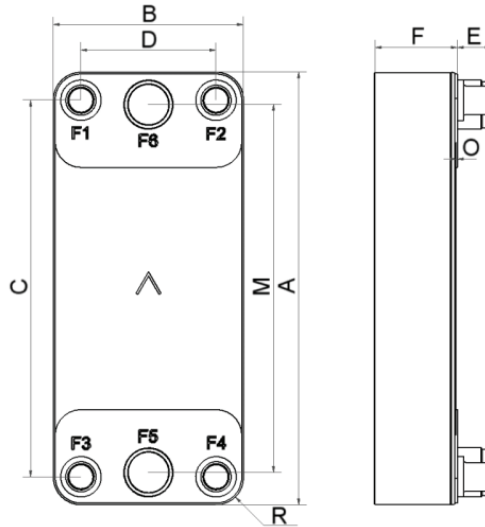

Measurements(mm)	Tolerance
A	+2 /-2
B	+2 /-2
C	+2 /-2
D	+2 /-2
E	+0 /-0
F	+0.5% /-2%
G	0
M	+1 /-1
R	+2 /-2

Port size F1/P1:	50mm
Port size F2/P2:	50mm
Port size F3/P3:	50mm
Port size F4/P4:	50mm
Port size F5/P5:	70mm
Port size F6/P6:	70mm

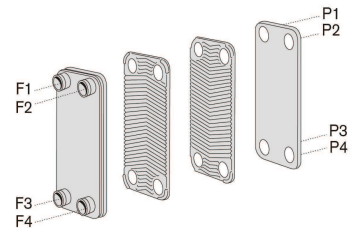

CBE port denomination

STANDARD CONNECTIONS

For specific dimensions, or information about other types of connections, please contact your SWEP sales representative.

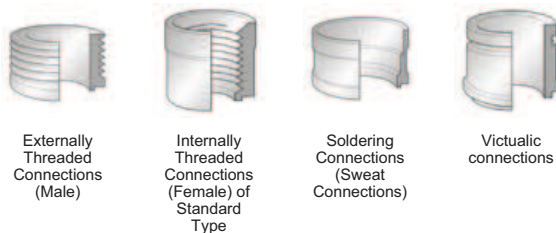

TECHNICAL DATA

Max working pressure at 155°C

Inner circuit: 31 bar (450psi)

Outer circuit: 28 bar (406psi)

Max working pressure at 225°C

Inner circuit: 27 bar (392psi)

Outer circuit: 25 bar (363psi)

Test pressure:

50 bar (725psi)

Min temperature:

-196°C (-321F)

Max temperature:

225°C (437F)

Max number of plates (NoP)

282

CBE weight

20.795+NoPx0.75kg

(45.8+NoPx1.7lbs)

Hold-up volume: inner circuit

(NoP/2-1)x0.406 litres

((NoP/2-1)x0.014 ft3.)

Hold-up volume: outer circuit

(NoP/2)x0.421 litres

((NoP/2)x0.015 ft3.)

Plate material:

AISI 316

Brazing material:

Pure Copper

Standard connection material

AISI 316

MATERIAL DISCLAIMER

The information and recommendations in regards to the products are presented in good faith, however, SWEP makes no representations or warranties as to the completeness or accuracy of the information. Information is supplied upon the condition that the purchasers will make their own determination as to the products' suitability for their purposes prior to use. Purchasers should note that the properties of the products are both application and material selection dependent and that products containing stainless steel, both 316 and 304 families, are still subject to corrosion if used in unsuitable environments. Purchasers should also be advised that stainless steel from the 304 family can be more sensitive in regards to corrosion than stainless steel from the 316 family. By purchasing products displayed here upon SWEP disclaims all responsibility due to corrosion of the products and/or other materials attached to the products and also for any damages resulting from the use of the products.



A DOVER COMPANY

SWEP INTERNATIONAL AB

Box 105, SE-261 22 Landskrona, Sweden
Phone +46 418 40 04 00
Fax +46 418 292 95
Internet: www.swep.net
E-mail: info@swep.net