



DBD47

COMPACT BRAZED HEAT EXCHANGER

High performance True Dual condenser: the DB-type

The DB47 is a highly effective, versatile True Dual that is a natural choice for flexible chillers and climate control applications. Its advantage is its ability to offer full performance at both full and half load.

Easy to choose the right product solution

With SWEP's unique SSP CBE, the SWEP Software Package, you can do advanced heat transfer calculations yourself, and choose the product solution that suits your application best. It's also easy to choose connections and generate drawings of the complete product. If you would like advice, or you would like to discuss different product solutions, SWEP offers all the service and support your need.

THIRD-PARTY APPROVALS (selection)

Europe, Pressure Equipment Directive (PED 97/23/EC)

For additional information please contact your local SWEP representative. SWEP reserves the right to make changes without prior notice.

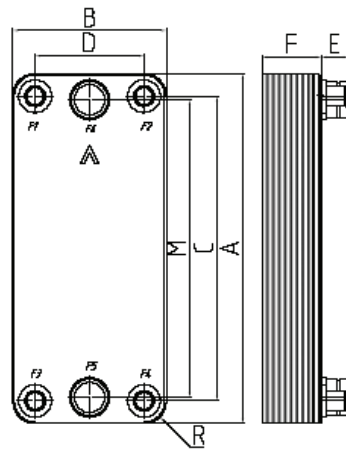

Measurements(mm)	Tolerance	
A	525	+2 /-2
B	243	+2 /-2
C	456	+2 /-2
D	174	+2 /-2
E	27.1 (opt. 54.2)	+1 /-1
F	10+2.34xNP	+0.5% /-2%
G	3	+1 /-1
M	456	+2 /-2
R	34	
Port size F1/P1:	33mm	
Port size F2/P2:	33mm	
Port size F3/P3:	33mm	
Port size F4/P4:	33mm	
Port size F5/P5:	42mm	
Port size F6/P6:	42mm	

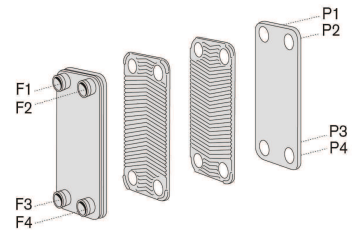

CBE port denomination

STANDARD CONNECTIONS

For specific dimensions, or information about other types of connections, please contact your SWEP sales representative.



Externally Threaded Connections (Male)



Internally Threaded Connections (Female) of Standard Type

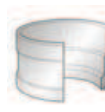

Soldering Connections (Sweat Connections)



Victualic connections

TECHNICAL DATA

Max working pressure at 155°C

Inner circuit: 31 bar (450psi)

Outer circuit: 28 bar (406psi)

Max working pressure at 225°C

Inner circuit: 27 bar (392psi)

Outer circuit: 25 bar (363psi)

Test pressure:

50 bar (725psi)

Min temperature:

-196°C (-321F)

Max temperature:

225°C (437F)

Max number of plates (NoP)

202

CBE weight

8.788+NoPx0.45kg

(19.4+NoPx1lbs)

Hold-up volume: inner circuit

(NoP/2-1)x0.237 litres

((NoP/2-1)x0.008 gal.)

Hold-up volume: outer circuit

(NoP/2)x0.234 litres

((NoP/2)x0.008 gal.)

Plate material:

AISI 316

Brazing material:

Pure Copper

Standard connection material

AISI 316

MATERIAL DISCLAIMER

The information and recommendations in regards to the products are presented in good faith, however, SWEP makes no representations or warranties as to the completeness or accuracy of the information. Information is supplied upon the condition that the purchasers will make their own determination as to the products' suitability for their purposes prior to use. Purchasers should note that the properties of the products are both application and material selection dependent and that products containing stainless steel, both 316 and 304 families, are still subject to corrosion if used in unsuitable environments. Purchasers should also be advised that stainless steel from the 304 family can be more sensitive in regards to corrosion than stainless steel from the 316 family. By purchasing products displayed here upon SWEP disclaims all responsibility due to corrosion of the products and/or other materials attached to the products and also for any damages resulting from the use of the products.