



Experience the true original: the B-type

The optimized B60 is the market's leading product for gas/liquid applications and provides optimal heat transfer when media with extreme volume differences are used. The asymmetric design of the channel plates makes it possible to use fluids at different flow rates. The exchanger is also designed for optimal cross flow.

Easy to choose the right product solution

With SWEP's unique SSP CBE, the SWEP Software Package, you can do advanced heat transfer calculations yourself, and choose the product solution that suits your application best. It's also easy to choose connections and generate drawings of the complete product. If you would like advice, or you would like to discuss different product solutions, SWEP offers all the service and support your need.

THIRD-PARTY APPROVALS (selection)

Europe, Pressure Equipment Directive (PED 97/23/EC)

For additional information please contact your local SWEP representative. SWEP reserves the right to make changes without prior notice.

B60

COMPACT BRAZED HEAT EXCHANGER

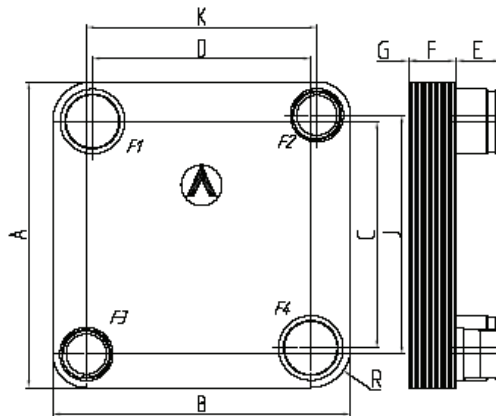

Measurements(mm)	Tolerance
A	374 +2 /-2
B	364 +1 /-1
C	277 +1 /-1
D	267 +1 /-1
E	54.2 +1 /-1
F	16+2.14xNP +0.5% /-1.5%
G	1.5 +1 /-1
J	292 +0 /-0
K	282 +0 /-0
L	49
	41

Port size	70mm
F1/P1:	
Port size	55mm
F2/P2:	
Port size	55mm
F3/P3:	
Port size	70mm
F4/P4:	

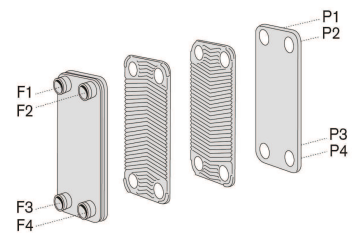

CBE port denomination

STANDARD CONNECTIONS

For specific dimensions, or information about other types of connections, please contact your SWEP sales representative.

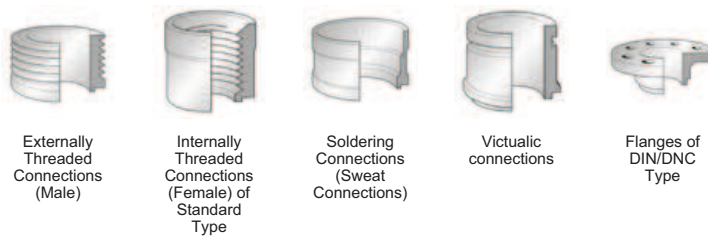

TECHNICAL DATA

Max working pressure at 155°C

Inner circuit: 31 bar (450psi)

Max working pressure at 225°C

Outer circuit: 31 bar (450psi)

Inner circuit: 27 bar (392psi)

Outer circuit: 27 bar (392psi)

Test pressure:

50 bar (725psi)

Min temperature:

-196°C (-321F)

Max temperature:

225°C (437F)

Max number of plates (NoP)

300

CBE weight

12.573+NoPx0.462kg

(27.7+NoPx1lbs)

(NoP/2-1)x0.223 litres

((NoP/2-1)x0.008 gal.)

Hold-up volume: inner circuit

Plate material:

AISI 316

Brazing material:

Pure Copper

Standard connection material

AISI 316

CAPACITY GRAPH

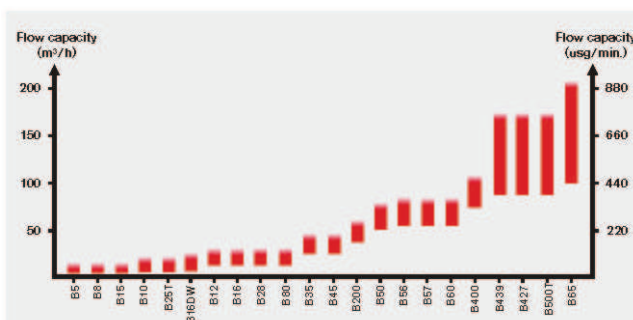

MATERIAL DISCLAIMER

The information and recommendations in regards to the products are presented in good faith, however, SWEP makes no representations or warranties as to the completeness or accuracy of the information. Information is supplied upon the condition that the purchaser will make their own determination as to the products' suitability for their purposes prior to use. Purchasers should note that the properties of the products are both application and material selection dependent and that products containing stainless steel, both 316 and 304 families, are still subject to corrosion if used in unsuitable environments. Purchasers should also be advised that stainless steel from the 304 family can be more sensitive in regards to corrosion than stainless steel from the 316 family. By purchasing products displayed here upon SWEP disclaims all responsibility due to corrosion of the products and/or other materials attached to the products and also for any damages resulting from the use of the products.